

# WorkForce WF-7710DWF



Expand your potential with this A3 4-in-1 inkjet. It offers high-quality, low-cost-printing and flexible wireless solutions including NFC<sup>1</sup>.

Think big with this high-quality 4-in-1 with single and double-sided printing, scanning and fax all up to A3. You'll stride through tasks with print speeds of 18ppm<sup>2</sup> in black and a 35 page A3 automatic document feeder (ADF). And that's not forgetting its cost-effective inks and flexible wireless connectivity solutions such as NFC<sup>1</sup> and Scan-to-cloud<sup>3</sup>.

## Professional A3 printing

This A3 4-in-1 printer will meet the needs of even the most demanding home office and small office users. It offers double-sided (duplex) printing, scanning and faxing all up to A3, plus its automatic document feeder can process up to 35 double-sided A3 pages. Furthermore, its PrecisionCore printhead produces high-quality, laser-like prints.

## Enhance your productivity

This efficient, reliable and fast model offers A3 double-sided printing and print speeds of 18ppm in black and 10ppm in colour<sup>2</sup>. It's also simple to operate directly thanks to its intuitive user interface and 10.9cm touchscreen.

## Minimise your outgoings

Dramatically reduce your costs; this printer offers up to 50 percent lower cost-per-page than competitors' laser models<sup>4</sup>. Giving great value for money, cartridges are available in standard, XL and XXL, with the highest yield delivering up to 2,200 pages<sup>5</sup>.

## Flexible wireless solutions

Print from anywhere in the office with Wi-Fi connectivity or use Wi-Fi Direct to print from compatible wireless devices without a Wi-Fi network. You can also print via NFC with a simple tap of a compatible Android device on the printer<sup>1</sup>. Epson's free mobile printing apps and solutions provide further versatility; Email Print allows you to send items to print from almost anywhere in the world<sup>3</sup>. And with Scan-to-Cloud, you can enjoy the benefits of collaborative working<sup>3</sup>.

## DATASHEET



## KEY FEATURES

- **High-quality A3 4-in-1**  
Double-sided print, scan, copy and fax - all up to A3
- **Fast business-quality printing**  
18ppm in black and 10ppm in colour<sup>2</sup>
- **Cost-effective inks**  
Up to 50% lower cost-per page than competitive lasers<sup>4</sup>
- **Wireless solutions**  
Ethernet, Wi-Fi, Wi-Fi Direct, NFC<sup>1</sup> and Scan-to-Cloud<sup>3</sup>
- **Epson's free mobile printing apps**  
Freedom to print and scan from almost anywhere<sup>3</sup>

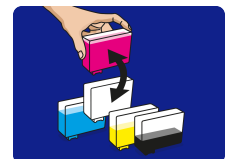

## PRODUCT SPECIFICATIONS

### TECHNOLOGY

Printing Method	PrecisionCore™ Print Head
Minimum Droplet Size	2.8 pl, With Variable-Sized Droplet Technology
Ink Technology	DURABrite™ Ultra

### PRINT

Printing Speed ISO/IEC 24734	18 pages/min Monochrome, 10 pages/min Colour
Duplex Printing Speed ISO/IEC 24734	8.7 A4 pages/min Monochrome, 6 A4 pages/min Colour
Maximum Printing Speed	32 pages/min Monochrome (plain paper), 20 pages/min Colour (plain paper)
Printing Resolution	4,800 x 2,400 dpi
Max Duty cycle	20,000 pages per month
Colours	Black, Cyan, Yellow, Magenta

For detailed information on printing speeds please visit <http://www.epson.eu/testing>.

### SCAN

Scanning Resolution	1,200 dpi x 2,400 dpi (Horizontal x Vertical)
Output formats	BMP, JPEG, TIFF, PDF, searchable PDF
Scanner type	Contact image sensor (CIS)

### FAX

Fax speed dials (max)	200 names and numbers
Page memory	Up to 550 pages/ 6MB (ITU-T No. 1 chart)
Fax Functions	Favorites, PC Fax, Auto Redial, Speed Dial

### PAPER / MEDIA HANDLING

Paper Formats	A3+, A3, A4, A5, A6, B4, B5, C4 (Envelope), C6 (Envelope), DL (Envelope), No. 10 (Envelope), Letter, 9 x 13 cm, 10 x 15 cm, 13 x 18 cm, 16:9, User defined, Legal
Automatic Document Feeder	35 pages
Duplex	Yes (A4/A3, plain paper)
Paper Tray Capacity	250 Sheets Standard, 250 Sheets maximum
Number of paper trays	1

### CONNECTIVITY

Interfaces	Hi-Speed USB - compatible with USB 2.0 specification, Ethernet interface (100 Base-TX / 10 Base-T), Wireless LAN IEEE 802.11b/g/n, Wi-Fi Direct, Near Field Communication (NFC)
WLAN Security	WEP 64 Bit, WEP 128 Bit, WPA PSK (TKIP), WPA PSK (AES)

### GENERAL

Energy Use	19 W (standalone copying, ISO/IEC 24712 pattern), 1.7 W (sleep mode), 8.5 W (Ready), 0.3 W (Power off), ENERGY STAR® qualified
Product dimensions	567 x 486 x 340 mm (Width x Depth x Height)
Product weight	18.5 kg
Compatible Operating Systems	Mac OS 10.5.8 or later, Windows 10, Windows 7, Windows 8, Windows Server 2003 (32/64bit), Windows Server 2008 (32/64bit), Windows Server 2008 R2, Windows Server 2012 (64bit), Windows Vista, Windows XP, Windows server 2003 R2

### OTHER

Warranty	12 months On-site service Optional warranty extension available
----------	--

## LOGISTICS INFORMATION

SKU	C11CG36411
EAN code	8715946631066
Country of Origin	Indonesia

For more information please contact:

Home users: 0343 90 37766  
Business users\*: 0871 42 37766  
Republic of Ireland: 01 436 7742  
Or visit us at <https://www.epson.co.uk/contactus>  
\* 10p per minute plus network extras.

Web: [www.epson.co.uk](http://www.epson.co.uk)  
[www.epson.ie](http://www.epson.ie)

Trademarks and registered trademarks are the property of Seiko Epson Corporation or their respective owners. Product information is subject to change without prior notice.

## WorkForce WF-7710DWF

### WHAT'S IN THE BOX

- CD Manual
- Driver and utilities (CD)
- Individual Ink Cartridges
- Main unit
- Power cable
- Quick Start Guide
- Software (CD)
- Warranty document

### INK YIELD DATA



Alarm clock  
27XL

Alarm clock  
27XXL

●	1,100 pages*	2,200 pages*
● ● ●	1,100 pages*	

\* Approx. page yield based on ISO/IEC 24711/24712 or ISO/IEC 29102/29103. Actual yield will vary depending on images printed and usage conditions. For more information visit <http://www.epson.eu/pageyield>

1. Requires NFC and Wi-Fi Direct enabled device with Android OS 4.0 or higher. Requires download of Epson iPrint app from Google Play.
2. Determined in accordance with ISO/IEC 24734 showing the average of ESAT from the Office Category Test for default A4 simplex. For more information, please visit [www.epson.eu/testing](http://www.epson.eu/testing)
3. Epson iPrint requires a wireless connection and the Epson printing app. Epson Email print, Epson Remote Print Driver and Epson Scan-to-Cloud require an internet connection. For more information, supported languages and devices, please visit [www.epsonconnect.eu](http://www.epsonconnect.eu)
4. For more information visit [www.epson.eu/inkjetsaving](http://www.epson.eu/inkjetsaving)
5. Approx. page yield based on ISO/IEC 24711/24712. Actual yield will vary depending on images printed and usage conditions. For more information visit [www.epson.eu/pageyield](http://www.epson.eu/pageyield)

**EPSON**®