

iFace800

Upgraded Face Capacity and Performance



With the latest ZK platform and algorithm, iFace800 can hold up to 1,200 faces and 2,000 fingerprint templates. It enables company to manage more employees with less terminals. Optional RFID provides more choices for customers to manage time & attendance and access control. It also supports multiple authentication methods including face, fingerprint, password, RFID card and their combinations, which makes iFace800 more applicable. Multi-model communications consisting of RS232/485, TCP/IP, USB host and Wi-Fi/GPRS (optional) allow an extremely easy data management. Optional built-in 2000 mAh battery eliminates the trouble of power failure.

It fulfills your need of managing the time & attendance and access control conveniently.

Features

- Capacity: 1,200 faces and 2,000 fingerprint templates
- Authentication methods: Face, Fingerprint, RFID/Password
- Elegant ergonomic design
- Intuitive touch screen GUI
- Optional built-in backup battery provides approx. 4 hours continuous operation
- Optional Wi-Fi or GPRS for wireless connection
- Built-in interfaces for third party electric lock, door sensor, alarm, exit button, or bell

Specifications

Fingerprint Sensor	ZK Optical Fingerprint Sensor
Camera	High Resolution Infrared Camera
Display	4.3" TFT Touch Screen
Face Capacity	1,200 (1:N)
Fingerprint Capacity	2,000
ID Card Capacity	10,000 (Optional)
Logs Capacity	100,000
Communication	TCP/IP, RS232/485, USB host (Optional: Wi-Fi/GPRS/3G)
Time Attendance Standard Functions	Photo ID, Automatic Status Switch, Self-Service Query, Work Code, T9 Input, 9 Digit User ID, DST, Scheduled-bell, Multiple Verify Mode
Access Control Interfaces for	Third Party Electric Lock, Door Sensor and Exit button
Wiegand Signal	Output
Optional Functions	2000 mAh Backup Battery, ID Card, Mifare Card, ADMS
Power Supply	DC 12V 3A
Verification Speed	≤2 sec
Operating Temp.	0- 45 °C
Operating Humidity	20%-80%
Dimension	193.6×165×111 mm (L×W×T)

Configuration

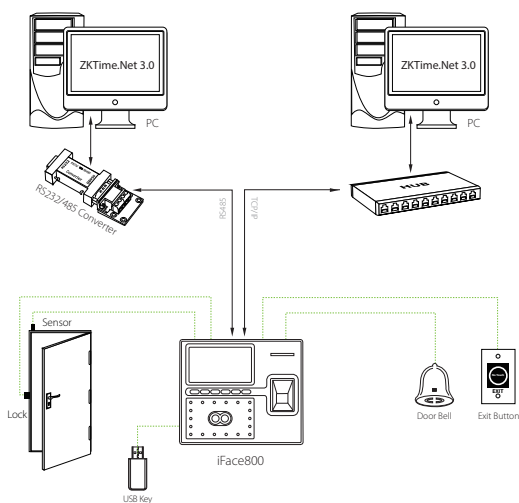

What's in the Box

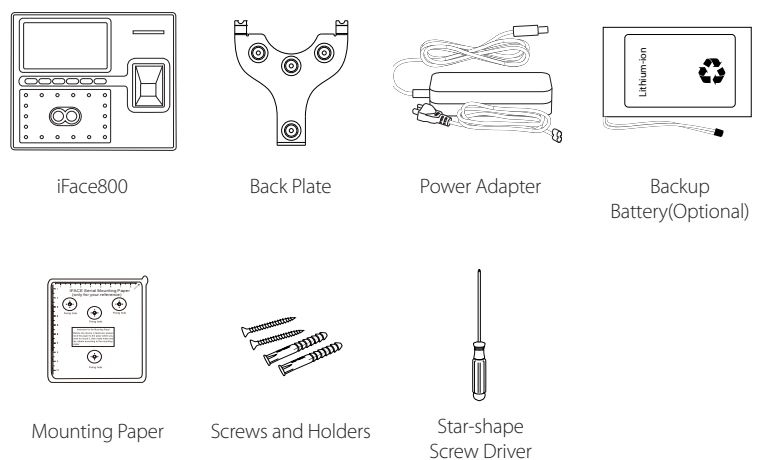

ZKTeco Inc.
E-mail: sales@zkteco.com
www.zkteco.com

© Copyright 2014. ZKTeco Inc. ZKTeco Logo is a registered trademark of ZKTeco or a related company. All other product and company names mentioned are used for identification purposes only and may be the trademarks of their respective owners. All specifications are subject to change without notice. All rights reserved.

